



## 37 Dovedale Road, Stockport, SK2 5DZ

Harratts Property Services is pleased to present this beautifully maintained and extended three-bedroom, semi-detached home, offering generous living accommodation spread over two floors. The property benefits from ample-sized gardens, off-road parking, and is ideally situated in a highly regarded location close to a range of local amenities, schools, bus routes, and only a short drive to both Hazel Grove and Stockport, making it an excellent choice for families and commuters alike.

Internally, the property begins with a welcoming entrance hallway, leading to the first-floor stairs. The bay-fronted lounge is a bright space, featuring a fireplace and views over the front garden. To the rear of the property, the extended kitchen/dining room is a fantastic family space, complete with a comprehensive range of eye and base-level units, an integrated hob, oven, and extractor fan, plus ample space for additional white goods. The kitchen area also provides direct access to the rear garden through French doors, making it ideal for outdoor dining and entertaining.

On the first floor, you'll find three well-presented bedrooms, including two generous double bedrooms, each offering ample space for storage and furniture, the third bedroom is also well-proportioned. The first-floor accommodation is completed by a family bathroom, which includes a bath with an overhead shower, a hand wash basin, and a

- Three Bedroom Semi-Detached Property
- Two Double Bedrooms
- Extended Kitchen/Diner
- Off Road Parking
- Detached Garage
- Close To Popular Schools
- Popular Residential Area
- Great Family Home

**£325,000**



Floor 0

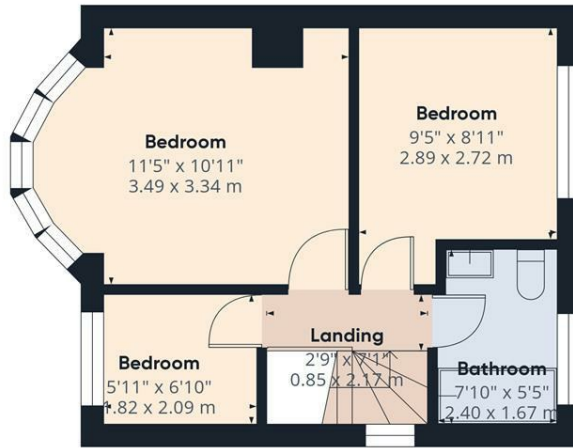

Floor 1

Approximate total area<sup>(1)</sup>  
847.45 ft<sup>2</sup>  
78.73 m<sup>2</sup>

(1) Excluding balconies and terraces

While every attempt has been made to ensure accuracy, all measurements are approximate, not to scale. This floor plan is for illustrative purposes only.

Calculations are based on RICS IPMS 3C standard.

GIRAFFE360

