



## 1 Brixham Walk, Bramhall, Stockport, SK7 2QH

Harratts Property Services are proud to present this exceptional two-bedroom end of terrace residence located in the highly sought-after area of Bramhall.

This charming property features a well maintained end of terrace design, offering a warm and inviting lounge/dining area alongside a well-equipped rear kitchen. The upper level comprises two double bedrooms, a well-appointed bathroom and boarded loft space which is perfect for extra storage.

Conveniently situated on Brixham Walk, this home is in close proximity to local amenities within Bramhall. Renowned for its desirable schooling options, Bramhall also benefits from a train line that provides frequent services to Manchester Piccadilly. With excellent transport links to Stockport town centre, this property is perfectly suited for commuters.

- **\*\*\* No Chain \*\*\***
- **End Of Terrace House**
- **Two Double Bedrooms**
- **Patio Garden**
- **Close To Local Schools & Shops**
- **Close To Transport Links**

**£260,000**

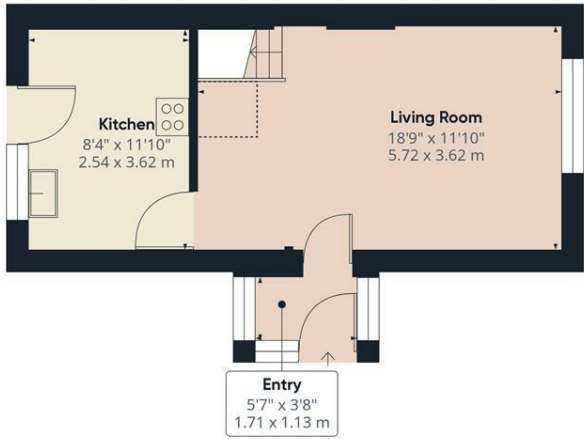

Floor 0

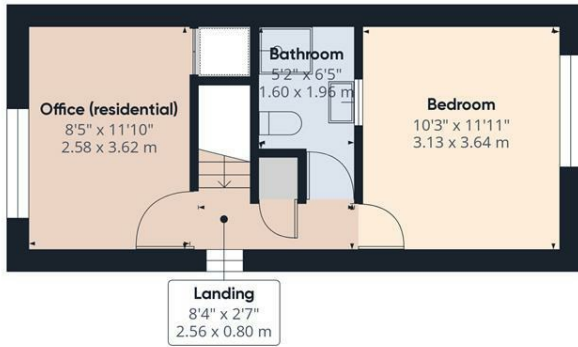

Floor 1

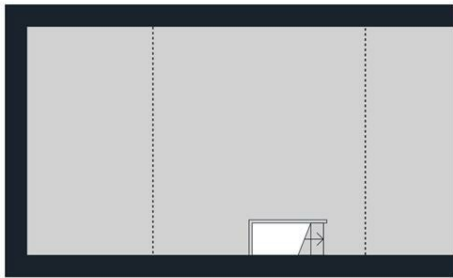

Floor 2

**Approximate total area<sup>(1)</sup>**  
 891.47 ft<sup>2</sup>  
 82.82 m<sup>2</sup>

**Reduced headroom**  
 129.38 ft<sup>2</sup>  
 12.02 m<sup>2</sup>

(1) Excluding balconies and terraces

Reduced headroom  
 ..... Below 5 ft/1.5 m

While every attempt has been made to ensure accuracy, all measurements are approximate, not to scale. This floor plan is for illustrative purposes only.  
 Calculations are based on RICS IPMS 3C standard.

GIRAFFE360

